





Floor Tiles  
Ground Level

-  Beaton Steel Grey Paver  
NT16-5155FL -  
(20mm thick) 600x600mm
-  Studio39 Londra Natural  
NT 19-6605 FL  
(Smooth Surface) 600x600mm
-  Studio39 Londra External  
NT 19-6645 FL  
(Textured Surface) 300x600mm
-  Mistura Dusk  
NT 18-2010 HB  
(Hybrid Flooring)



**REVISED**  
7:15 pm, Oct 05, 2020

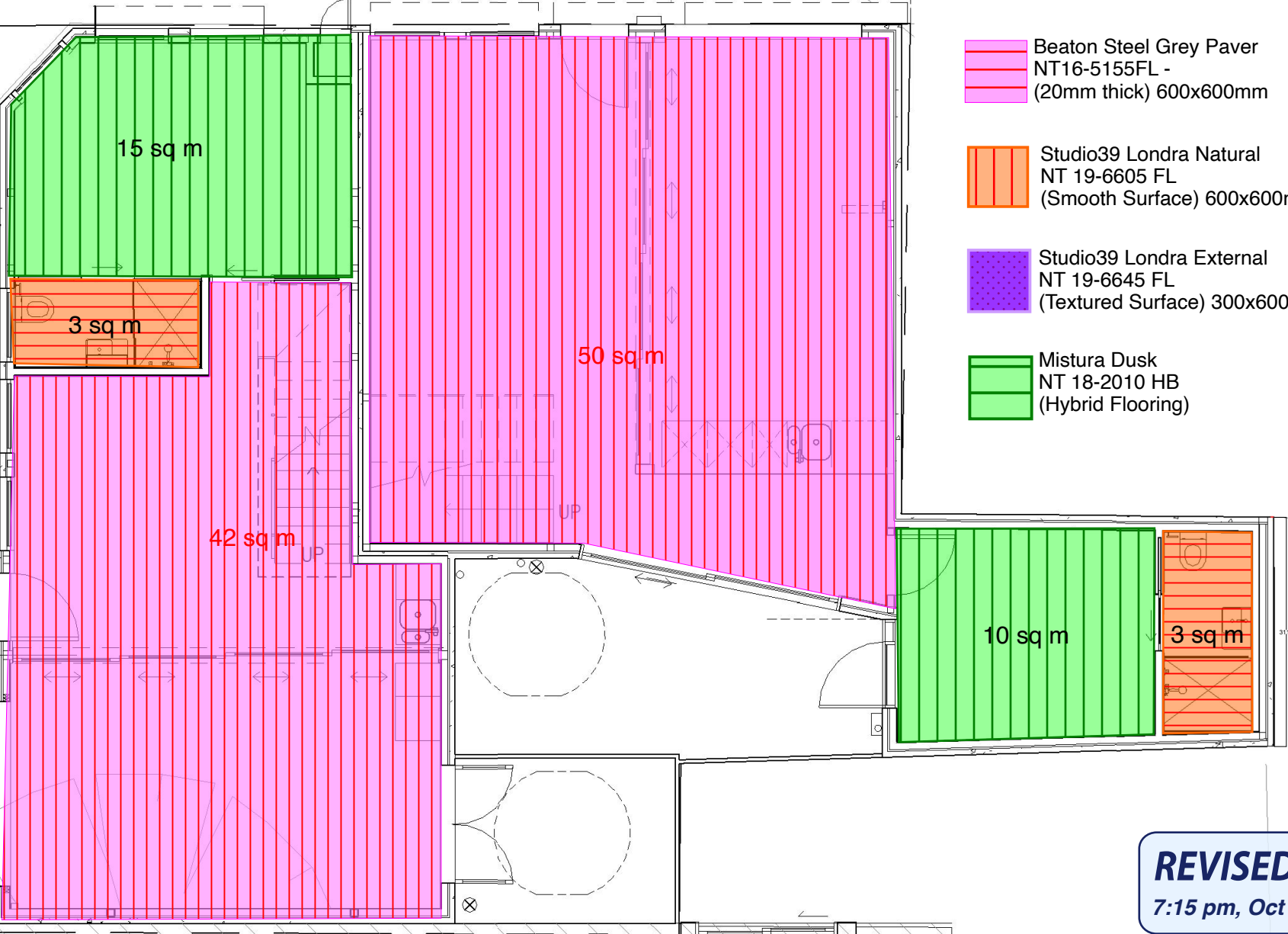
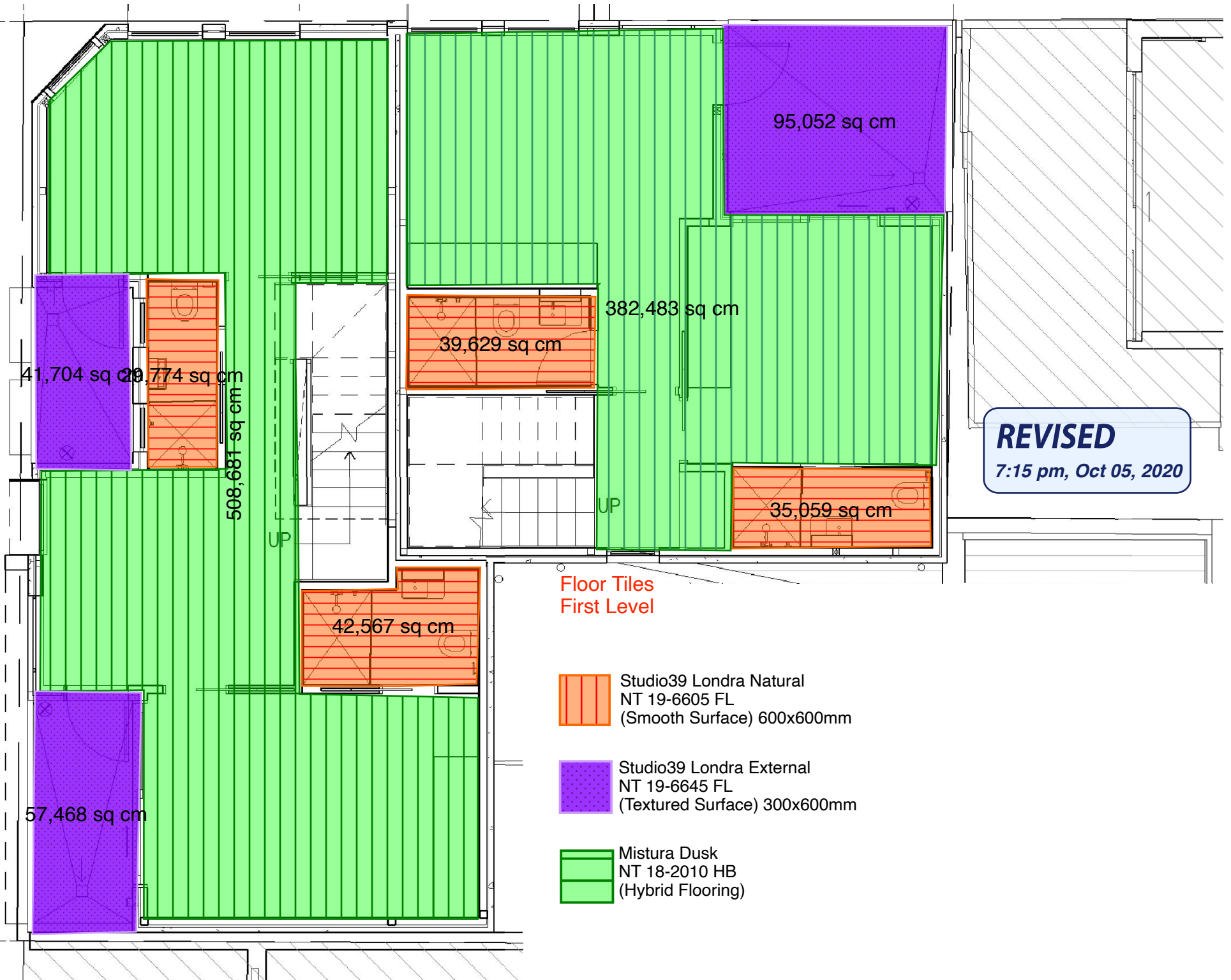

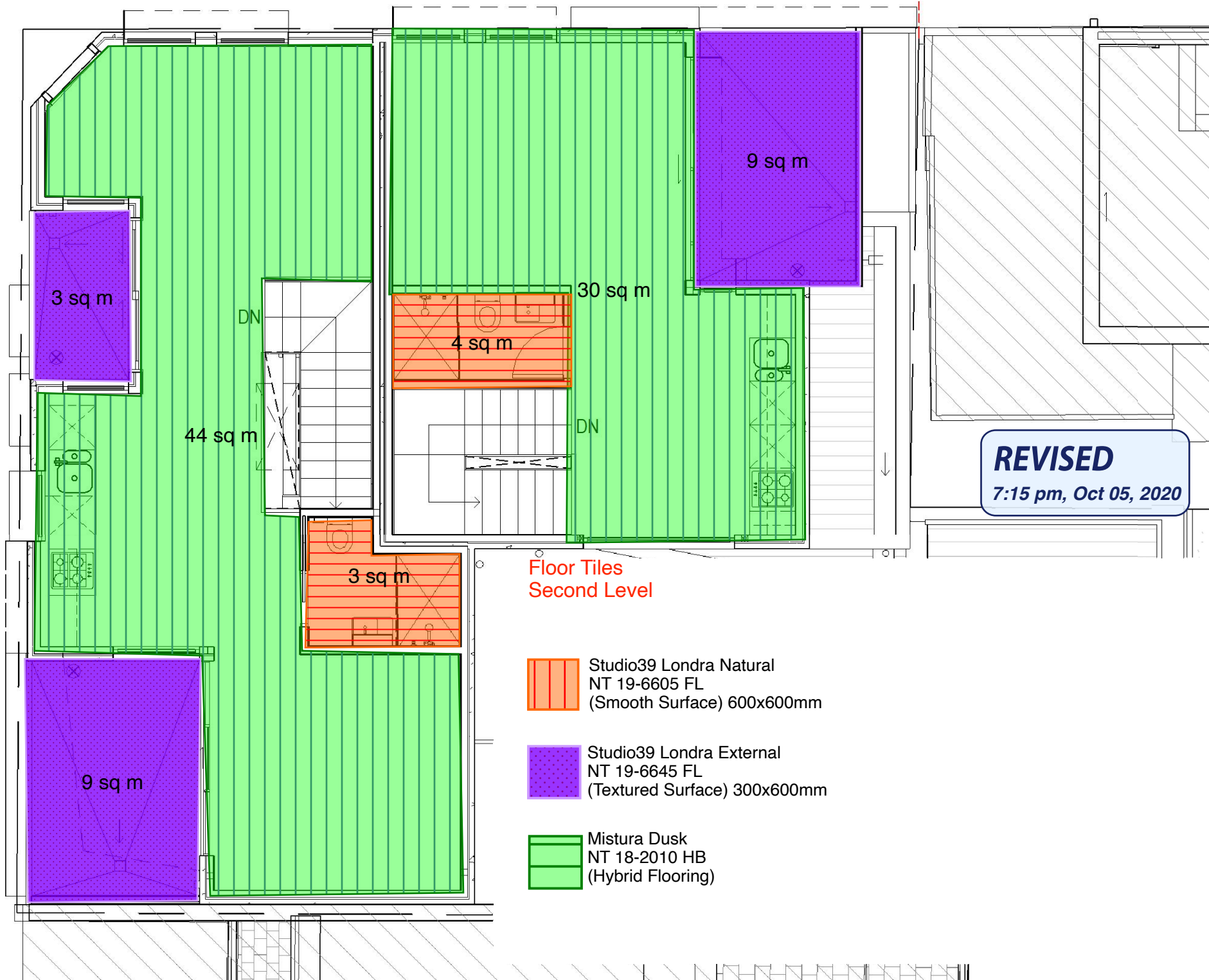



**REVISED**  
7:15 pm, Oct 05, 2020

**Floor Tiles  
Second Level**

 Studio39 Londra Natural  
NT 19-6605 FL  
(Smooth Surface) 600x600mm

 Studio39 Londra External  
NT 19-6645 FL  
(Textured Surface) 300x600mm

 Mistura Dusk  
NT 18-2010 HB  
(Hybrid Flooring)

44 sq m

3 sq m

9 sq m

4 sq m

3 sq m

30 sq m

9 sq m

DN

DN

# Raphael-G1\_Wall Tiled Garage

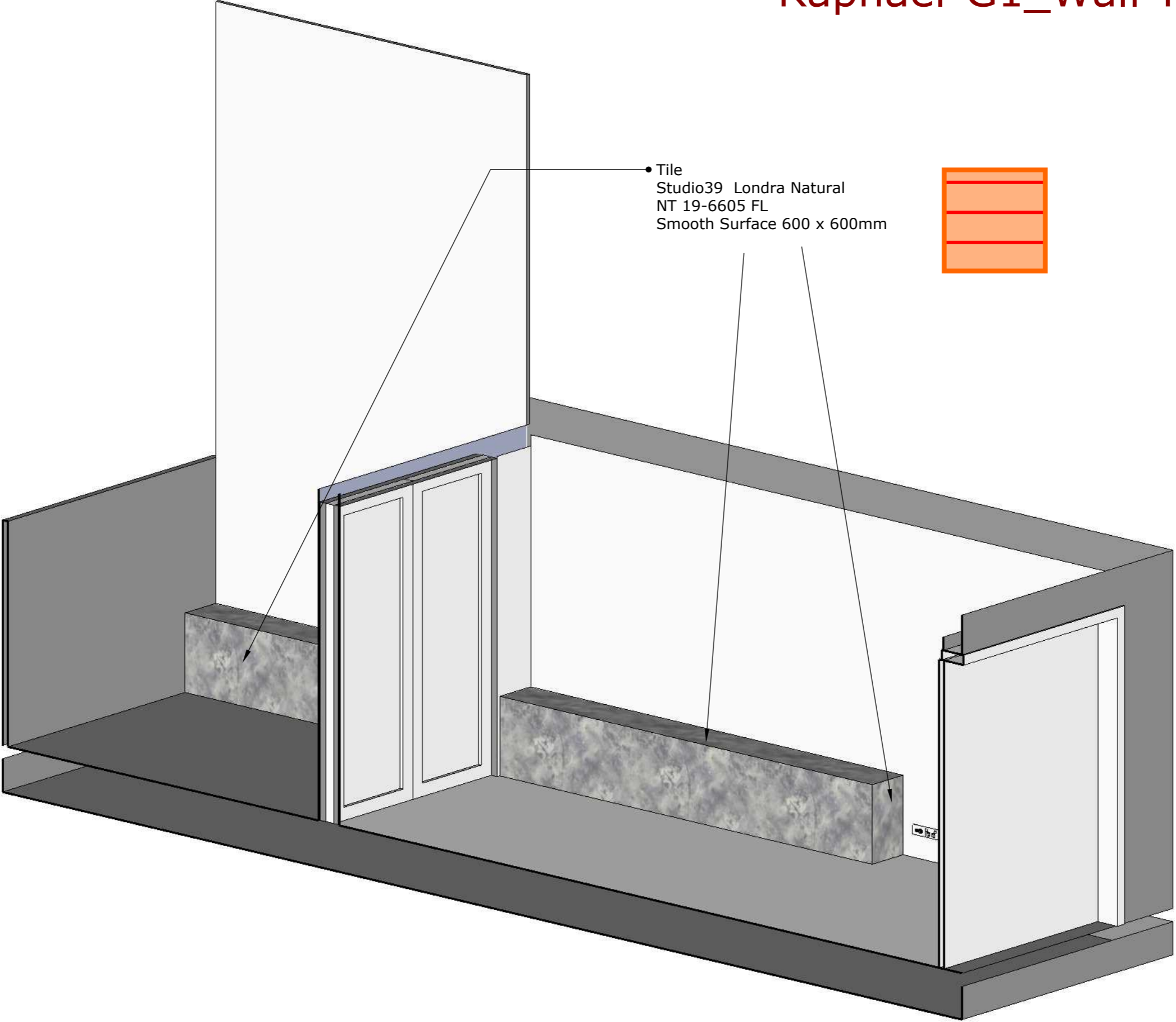

• Tile  
Studio39 Londra Natural  
NT 19-6605 FL  
Smooth Surface 600 x 600mm

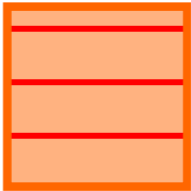

**REVISED**  
7:15 pm, Oct 05, 2020