

Suitable for all exterior conditions, porcelain pavers are the ideal product for outdoor environments that require slip resistance and durability.

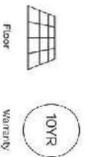

FREE online metro delivery over \$300!

Home / Beaton Steel Grey Paver

surface finish - grip tiles

Grip Tiles have a rougher surface, making them less slippery. They have a light sand texture embedded in the grout. Grip finish tiles are ideal for swimming pools, balconies and other areas that require non-slip surfaces. These tiles are not recommended for high traffic indoor areas such as bathrooms and kitchens.

material - porcelain

Porcelain tiles go in sync with well-appointed furnishings of homes and offices because they offer unmatched variety of colours, shapes and sizes. A creative expression of your personality on your surfaces, these fully vitrified porcelain tiles are highly durable with a longer life span than other tiles. They are preferred rendering them the safest choice for homes and offices. That's not all. They are ideal for outdoor use such as pools with high foot traffic and are the perfect solution for cold climates because of their frost-proof exterior. Their strength and non-porous nature make them highly resistant to staining. You can lay them by using an adhesive, grout and silicone sealant.

edge - rectified

Rectified tiles are mechanically trimmed during manufacturing, generally with a watered diamond blade allowing for smaller grout joints. The smaller grout joints give a seamless look to the floor and some sizes and have square edges. They are preferred for high traffic areas as they are ideal when thin, clean and precise grout lines are required.

product specifications

SKU	NT16-515FFL
Series	BEATON
Warranty	STANDARD (10 Yrs Tiles)
Style	Classic
Look/Design	Stone
Slip Rating	N/A
Pendulum Rating	P5
Size	600x600
Surface Finish	Grip Tiles
Thickness	20
Colour	Steel Grey
Material	Porcelain
Area	Floor
Edge	Rectified
Unit of Measure	M2
Length	600
Width	600

PRODUCT CATALOG

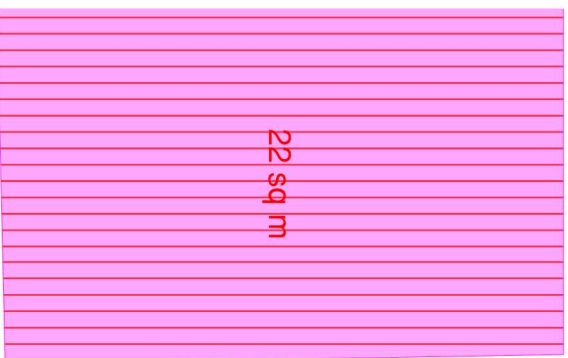

Show

Beaton Steel Grey Paver

★★★★★ 2 reviews

2 people have viewed this product today

\$ **79.95** PER SQM



size **600x600**

surface finish **Grip Tiles**

colour

Enter quantity In Stock! 19138 sqm Left

0

\$ **0.00**

Total Cost

We give back from every sale with **I=Change™** 10%.

Add to Cart

Estimated online dispatch is Friday 28 May. If ordered by noon on Monday 1 June, it ordered ship from.

Add sample to cart 100 x 100mm sample tile

overview

product specs / catalogue

product review

delivery / pickup

overview